

OUTPUT 12V DC/ 49.92 W AC/DC POWER CONVERTER

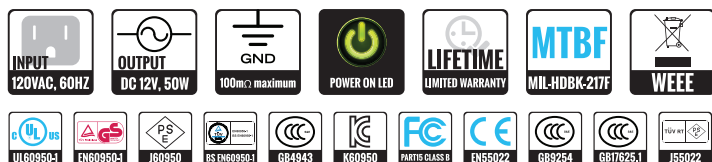

MODEL #		VZ-PSU2
FEATURES		
Input Voltage	100 ~ 240V AC, 50/60Hz	
Output Voltage	12V DC	
Output Watt	49.92 W	
Output Current	4.16 A	
PROTECTION		
Short-Circuit Protection	The power supply shall not be damaged by shock between DC output and DC ground	
Over-Voltage Protection	20V DC maximum auto-recovery function	
Over-Current Protection	8A maximum with auto-recovery function	
DIMENSIONS & WEIGHT		
Dimensions (Width x Length x Height) inch	2.24 x 4.81 x 1.34	
(Width x Length x Height) mm	57 x 122.3 x 34.1	
Gross Weight	0.58 lbs / 0.265kg	
INTERFACE		
Input Plug Type	IEC320 C14 AC PIN	
Output Cord	WIRE: 18AWG /1C+5H 1185, 1500mm PLUG: JACK PLUG 5.5*2.5*10.5mm	
GENERAL		
Construction	PC, ABS, or equivalent	
Regulations	SAFETY STANDARDS UL/CUL(UL60950-1),TUV-GS(EN60950-1), PSE (J60950), T-LICENSE(BS EN60950-1), CCC(GB4943),KC-MARK(K60950)	
	EMI STANDARDS FCC(PART15 CLASS B), CE(EN55022), GB9254,GB17625.1, PSE(J55022)	
Operating Humidity	20% ~ 85% RH. Non-condensing	
Storage Humidity	5% ~ 95% RH. Non-condensing	
Operating Temperature	32°F ~ 104°F / 0°C ~ +40°C (10-90%R.H)	
Storage Temperature	-4°F ~ 140°F / -20°C ~ +60°C (10-90%R.H)	
Cable	UL AWM Style 1185 - 18 AWG/1C + SH	
Cooling	Cooling shall be with natural convection cooling	

VZ-PSU2 ADVANTAGES

- AC Input - 100~240V, 50/60Hz
- DC Output - 12V ∓ 4.16A / 49.92 W
- Green Power On LED
- Energy efficiency rating: V
- Compact & Lightweight
- Safe & Reliable
- Complies with International Safety Standards & Environmental Protection Requirements
- Over Voltage / Overload / Over current / Short Circuit Protection
- Comply with Environmental Protection Requirements
- Wide Voltage Compatibility
- Long Product Life, MTBF of 50,000 hours
- EMC meets IEC55013/55020/55022/55024/61000 international standard
- Safety : UL, KCC, CCC, TUV/GS, PSE, RCM
- EMI : CE, FCC/UL, CCC, PSE

INTERFACE

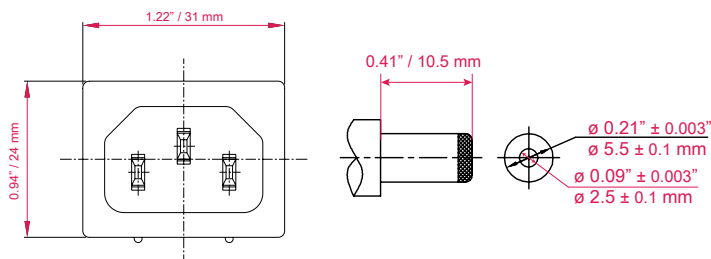

INPUT
IEC320 C14 AC PIN
100 ~ 240 VAC

OUTPUT
DC MATE PLUG
12V / 4.16 A

PRECAUTIONS



Risk of electric shock. Do not open the body.

Contact ViewZ

- Address : 177 W. Orangethorpe Ave., Placentia, CA 92870
- Phone : (714) 996-1177, Fax : (714) 996-1138
- Sales : sales@viewzusa.com
- Specification subject to change without notice.

DIMENSIONS

*(O.D.)
 $\varnothing 0.21" \pm 0.003" / \varnothing 5.5 \pm 0.1$ mm
 *(I.D.)
 $\varnothing 0.09" \pm 0.003" / \varnothing 2.5 \pm 0.1$ mm

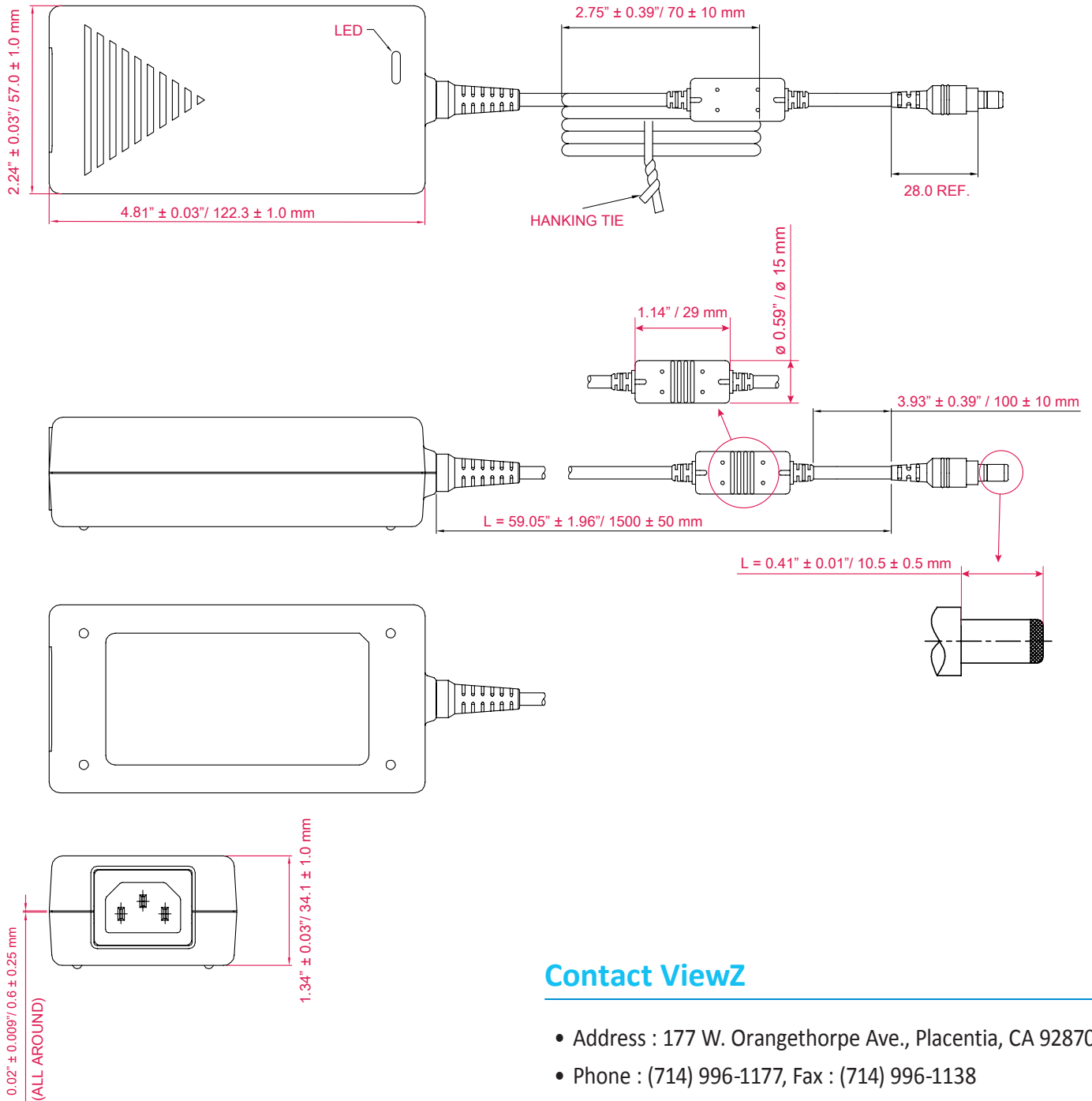

Contact ViewZ

- Address : 177 W. Orangethorpe Ave., Placentia, CA 92870
- Phone : (714) 996-1177, Fax : (714) 996-1138
- Sales : sales@viewzusa.com
- Specification subject to change without notice.