

Universal Magnalock® Accessories

IK Installation Kit

- This convenient, cost effective kit contains everything an installer needs to achieve professional, high quality Securiton Magnalock® installations. The IK offers substantial savings over purchasing the same items separately.
- MagnaCare® lifetime replacement, no fault, no questions asked warranty

Securiton's original installation kit includes the following components:

Tool Box	Rubber Washers	1/2" High Speed Drill Bit
Heavy Duty Drill Guide	Flat Washers	Blind Nuts with
Blind Nut Placement Tool	Insulated Crimp Connectors	Collapsing Tool
Sex Bolt – M32/M62/M82	Threadlock	Finish Caps
T-Handle Hex Wrench	1/8" Cobalt Drill Bit	Long Screw Pack
Hardware Packs –	3/8" Cobalt Drill Bit	
M32, M62/M82	3/8" Carbide Drill Bit	



Part Number | Description

IK	Installation Kit
-----------	------------------

Glass Door Accessories

- HEB-3G allows for Magnalock installation on all-glass header when used with AKG
- GDB permits strike plate installation on a solid glass door
- AKG permanently bonds to the glass using a special industrial adhesive
- Strike Plate screws into the bracket, as glass doors cannot be drilled
- Use HEB-3G with M32, M62, 3" x 3" x 8" with specially milled back

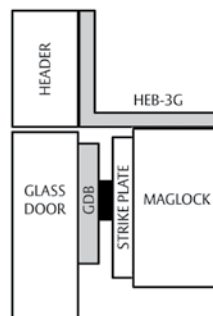

Part Number | Description

AKG	Adhesive Kit for GDB
GDB	Glass Door Bracket
DCP-12X3	Dress Cover Plate, 12 x 3 for larger strikes (M680, M380)



Securitron Magnalock Accessories *continued*

HEB Header Extension Bracket

- 90 degree angle brackets
- Extends narrow headers to permit proper mounting of Magnalocks
- Use with M32, M62, M82, M38, M68, M370, M380, M670, M680
- Available in clear aluminum or black anodized
- MagnaCare® lifetime replacement, no fault, no questions asked warranty



Part Number | Description

HEB-1BK-12	HEB - 1 x 1 x 12, Black Anodized
HEB-1BK-8	HEB - 1 x 1 x 8, Black Anodized
HEB-1CL-12	HEB - 1 x 1 x 12, Clear Anodized
HEB-1CL-8	HEB - 1 x 1 x 8, Clear Anodized
HEB-2BK-12	HEB - 2 x 2 x 12, Black Anodized
HEB-2BK-8	HEB - 2 x 2 x 8, Black Anodized
HEB-2CL-12	HEB - 2 x 2 x 12, Clear Anodized

Part Number | Description

HEB-2CL-8	HEB - 2 x 2 x 8, Clear Anodized
HEB-3BK-12	HEB - 3 x 3 x 12, Black Anodized
HEB-3BK-8	HEB - 3 x 3 x 8, Black Anodized
HEB-3CL-12	HEB - 3 x 3 x 12, Clear Anodized
HEB-3CL-8	HEB - 3 x 3 x 8, Clear Anodized
HEB-3G	HEB - 3 x 3 x 8 for Glass Door, Clear Anodized

UHB Universal Header Bracket

- Used to extend the header 1" or 1-1/2"
- Provides a concealed wiring chamber
- Use with M32, M62, M82, M38, M68, M370, M380, M670, M680
- Available in clear aluminum or black anodized
- MagnaCare® lifetime replacement, no fault, no questions asked warranty



Part Number | Description

UHB-BK-12	UHB - 12", Black Anodized
UHB-BK-8	UHB - 8", Black Anodized
UHB-CL-12	UHB - 12", Clear Anodized
UHB-CL-8	UHB - 8", Clear Anodized



MagnaCare
Warranty

Securitron Magnalock Accessories *continued*

SFP Stop Filler Plate

- Used to fill or extend a door stop
- Creates a flat mounting surface for the Magnalock®
- Available in 1/4", 3/8", 1/2" and 5/8" thickness, all 1-1/4" wide
- Use with M32, M62, M82, M38, M68, M370, M380, M670, M680
- Available in clear aluminum or black anodized
- MagnaCare® lifetime replacement, no fault, no questions asked warranty

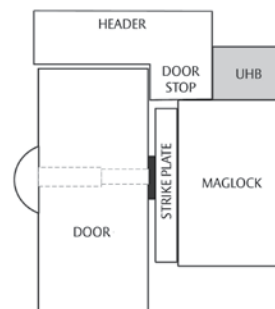

Part Number | Description

SFP-1/2BK-12	SFP - 1/2 x 1-1/4 x 12, Black Anodized
SFP-1/2BK-8	SFP - 1/2 x 1-1/4 x 8, Black Anodized
SFP-1/2CL-12	SFP - 1/2 x 1-1/4 x 12, Clear Anodized
SFP-1/2CL-8	SFP - 1/2 x 1-1/4 x 8, Clear Anodized
SFP-1/4BK-12	SFP - 1/4 x 1-1/4 x 12, Black Anodized
SFP-1/4BK-8	SFP - 1/4 x 1-1/4 x 8, Black Anodized
SFP-1/4CL-12	HEB - 2 x 2 x 12, Clear Anodized
SFP-1/4CL-8	SFP - 1/4 x 1-1/4 x 8, Clear Anodized

Part Number | Description

SFP-3/8BK-12	SFP - 3/8 x 1-1/4 x 12, Black Anodized
SFP-3/8BK-8	SFP - 3/8 x 1-1/4 x 8, Black Anodized
SFP-3/8CL-12	SFP - 3/8 x 1-1/4 x 12, Clear Anodized
SFP-3/8CL-8	SFP - 3/8 x 1-1/4 x 8, Clear Anodized
SFP-5/8BK-12	SFP - 5/8 x 1-1/4 x 12, Black Anodized
SFP-5/8BK-8	SFP - 5/8 x 1-1/4 x 8, Black Anodized
SFP-5/8CL-12	SFP - 5/8 x 1-1/4 x 12, Clear Anodized
SFP-5/8CL-8	SFP - 5/8 x 1-1/4 x 8, Clear Anodized

