

Four-door Access Controller

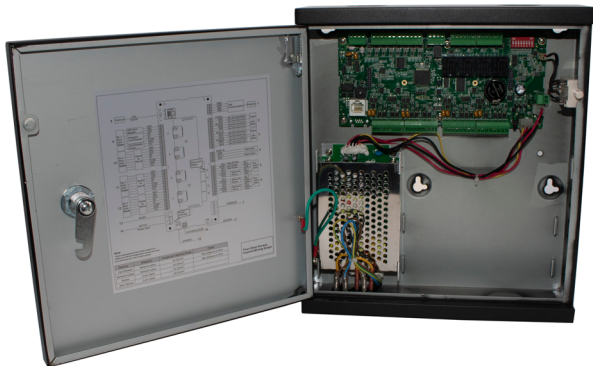

- Includes vented enclosure and pre-wired power supply
- Removable terminal blocks support ease of wiring
- Scalable up to 64 four-door controllers managed by SmartPSS
- Supports controlled lock down of all connected access doors
- Easily integrate biometrics to secure sensitive locations
- Enable anti-passback and multi-door interlock to control traffic in high security applications



Technical Specification

System	
Main Processor	32-bit ARM Cortex-M3
Memory	16 MB (32 MB external)
Input/Output Ports	
Inputs	Nine (9) Normally Open, Supervised Inputs, 0 VDC to 5 VDC nominal: <ul style="list-style-type: none"> • Maximum Power for Relay Input • Four (4) Door Sensors • Four (4) Exit Buttons • One (1) Alarm
Outputs	Five (5) Dry Relays: <ul style="list-style-type: none"> • Four (4) Lock Relays Form C, 3 A at 24 VDC maximum¹ • One (1) Alarm Relay, Switching Signal Type, 1 A at 24 VDC maximum
Readers	Four (4) Reader Inputs <ul style="list-style-type: none"> • 11 VDC to 13 VDC, current limited • 300 mA, maximum per port
Capacity	
Card Holders	100,000
Events	150,000
Functions	
Unlock Modes	Card, Fingerprint, Password, Card + Password, Card or Password, Card + Fingerprint, Fingerprint + Password, and By Period
User Management	General, VIP, Guest, Patrol, Black List, Duress
Alarm Function	<ul style="list-style-type: none"> • Door time-out Alarm • Intrusion Alarm • Duress Alarm • Tamper Alarm
Schedule Settings	Schedule: 128 Groups Period: 128 Groups Holiday: 128 Groups
Interface	
Reader Compatibility ²	
Wiegand Reader Data	24 AWG, 5 conductor stranded cable without shield, 40.0 m (131.23 ft), maximum
RS485 Reader Data	24 AWG, 120 Ω Impedance, 3 conductor stranded cable without shield, 100.0 m (328.08 ft) maximum. Use a separate power supply to extend the RS485 reader data up to 1000.0 m (3280.84 ft), maximum
Network Compatibility	TCP/IP, RJ-45 (10/100 Mbps)

Operations

Power Supply	Power Cable Included
Primary Voltage Input	100 VAC to 240 VAC, 1.5 A, 47 Hz to 63 Hz
Secondary Voltage Input	9 VDC to 15 VDC, 500 mA
Battery Charging Circuit	13.8 VDC at 1 A Use only a 12 VDC, 7000 mAh sealed rechargeable lead acid type battery (includes one 11-in. battery cable) ³
Operating Temperature	-30° C to +60° C (-22° F to +140° F), ≤ 95%
RTC	Support

Construction

Dimensions	280.0 mm x 320.0 mm x 114.0 mm (11.02 in. x 12.60 in. x 4.49 in.)
Net Weight	2.0 kg (4.41 lb)

Certifications

Safety	UL 60950-1 & CAN/CSA C22.2 No. 60950-1-07 EN 60950:2006+A2:2013
Electromagnetic Compatibility (EMC)	FCC CFR 47 Part 15 subpart B EN 55022:2010/AC:2011 (Class B) EN 55024:2010, EN 50130-4:2011, EN 61000-6-3:2007/A1:2011 EN 61000-3-2:2006+A1:2009+A2:2009 EN 61000-3-3:2013, IEC 61000-4-2:2008, IEC 61000-4-3:2006+A1:2007 IEC 61000-4-4:2012, IEC 61000-4-5:2005, IEC 61000-4-6:2008, IEC 61000-4-8:2009 IEC 61000-4-11:2004

Dimensions (mm/in.)

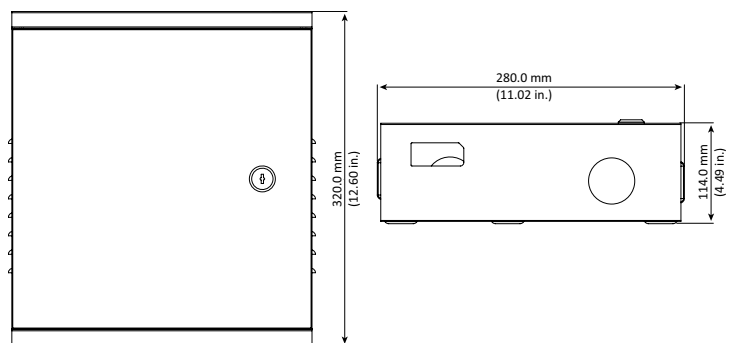

1. A 12/24 VDC external power supply is required to supply power to door locks.
2. Larger gauge cable will not extend stated maximum distance.
3. Recommended battery not included. Recharge time depends on current load of the panel. Maximum recharge time is 10 hours at full load.